

ISSUE:	CRF NO:
h	0691
DRAWN:	SIGNATURE:
CHECK'D:	DATE:

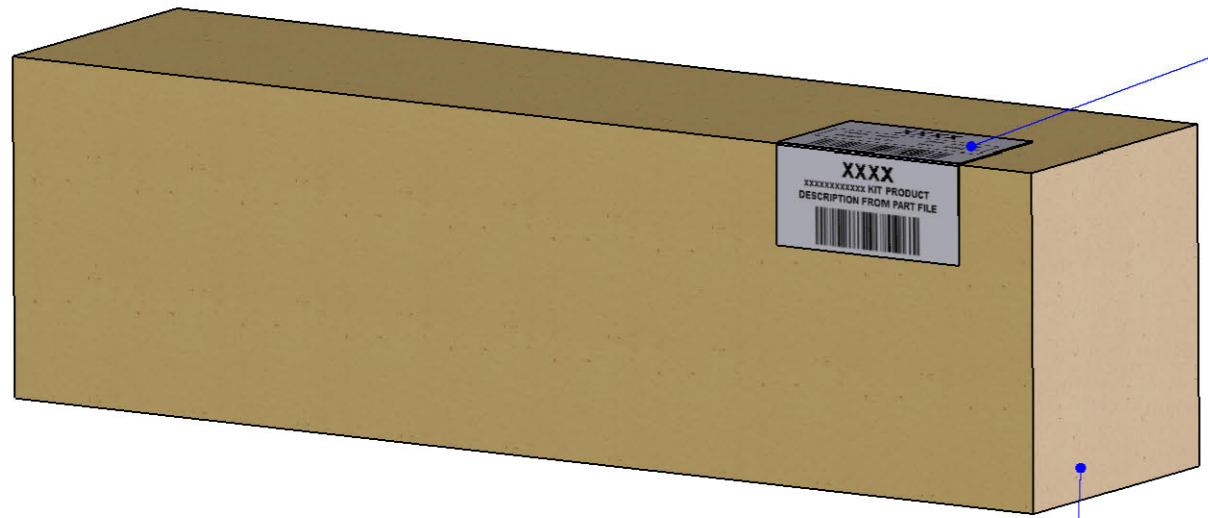

LA038 x1
Printed Label, Kit Box

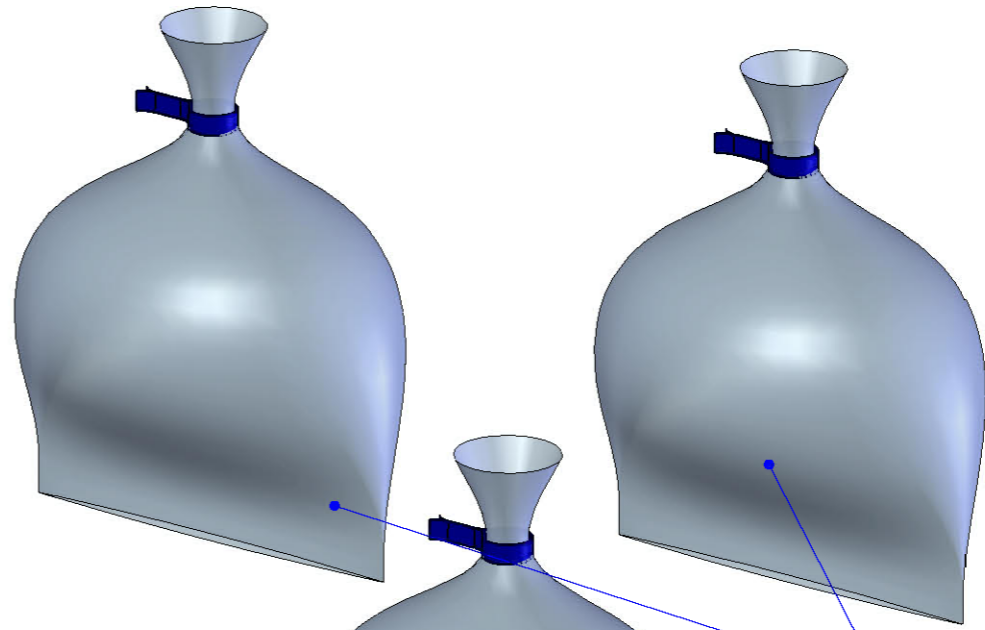

BX89 x1
Fitting Kit Box Assembled, Standard, TGS

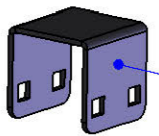

MS161 x 8
25 x 40 Standard Saddle, M8

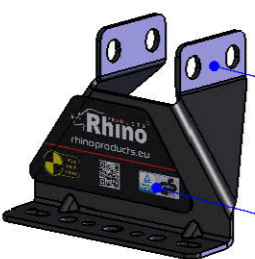

MS168 x 4
MC Leg, Bars / Modular Racks



MS199 x 4
T5 Inner Leg, Bars / Modular Racks

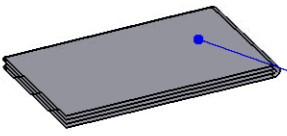

(INT54R) x1
Customer Instruction Sheet(s)

LA030 x 4
Leg Label, Standard

LA029 x 4
Leg Label, Standard

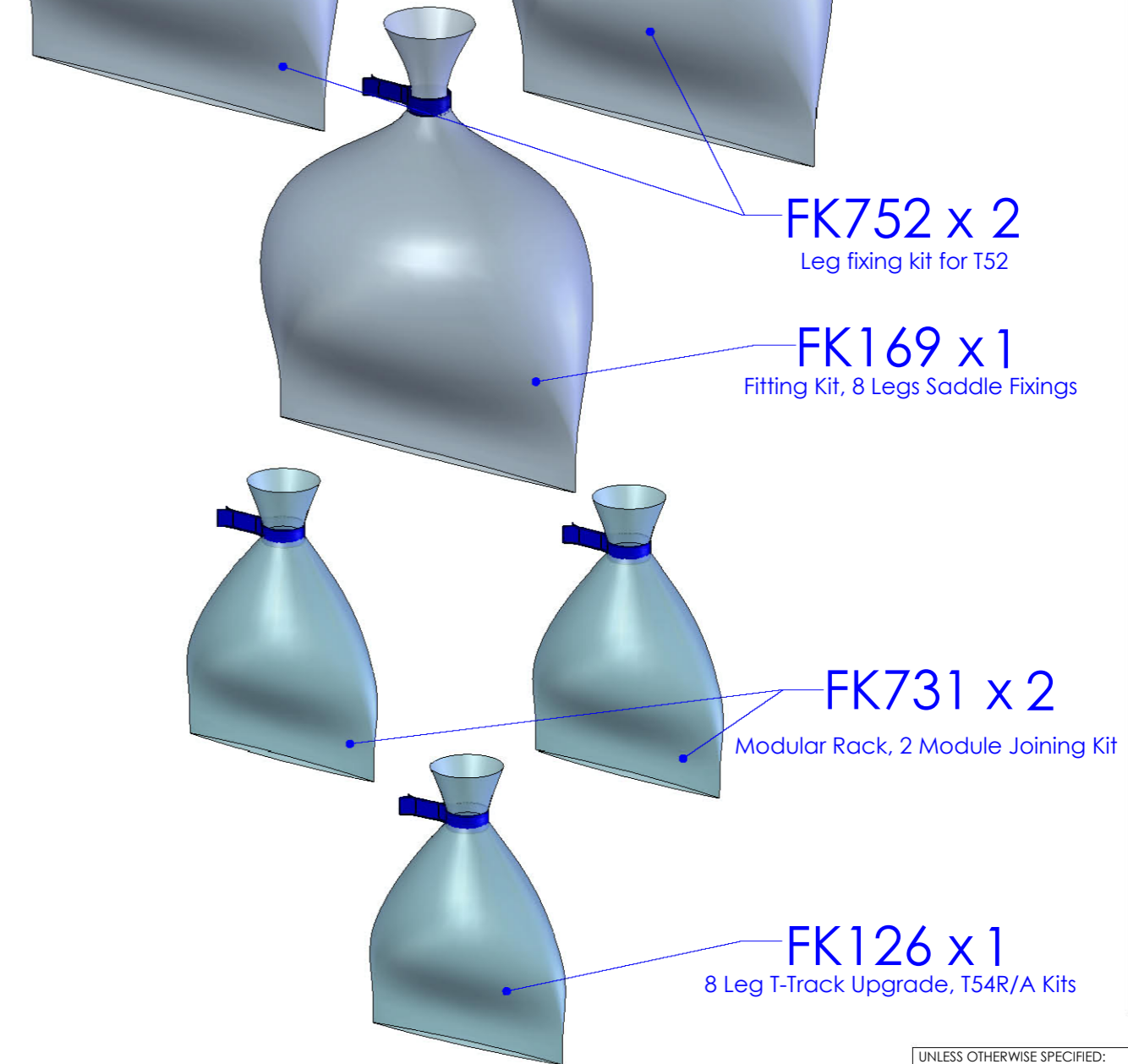

FK752 x 2
Leg fixing kit for T52

FK169 x1
Fitting Kit, 8 Legs Saddle Fixings

FK731 x 2
Modular Rack, 2 Module Joining Kit

FK126 x1
8 Leg T-Track Upgrade, T54R/A Kits

- Notes:
1. Fit Labels to Legs as shown above.
 2. Fold Printed Label along edge of Kit Box.
 3. Put through heat tunnel.

© NOTE: This drawing is the property of RHINO PRODUCTS Ltd and must not be used or copied without written consent. The RHINO PRODUCTS name and logo must remain clearly visible in any reproduction.

DRAWING NO: T54R (1 of 5)	DESCRIPTION: "T5" 8 Leg Fitting Kit, Modular Racks	DESIGNED BY: K. Broadbent 12/12/06
MATERIAL SIZE: n/a	MATERIAL SPEC: n/a	WEIGHT: 4.24Kg
	FINISH: n/a	

UNLESS OTHERWISE SPECIFIED:	
DIMENSIONS ARE IN MM	
0.00	+0.2
0.0	+0.5
ANG	+0.5 °
DERIVED DIMENSIONS SHOWN IN BRACKETS	
DEBURR AND BREAK ALL SHARP EDGES	
SHEET SIZE A3	SHEET SCALE: 2:7

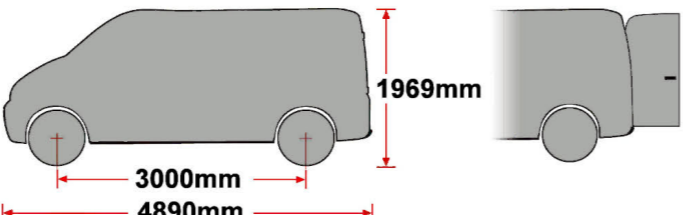
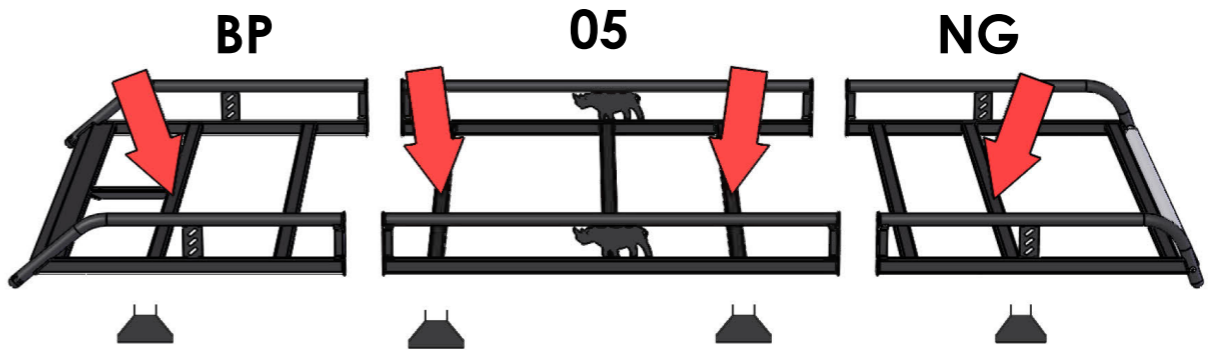
<h2>EU/R 507</h2>  <p>45kg + xx kg = Max. 150kg</p>	<h3>T5 TRANSPORTER 2002-SWB, LOW ROOF, TWIN DOORS</h3>  <p>3000mm 4890mm 1969mm</p>	 <p>BP O5 NG</p>
--	---	---

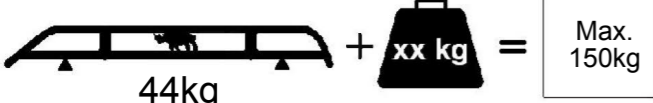
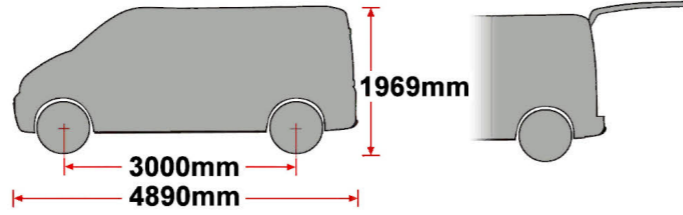
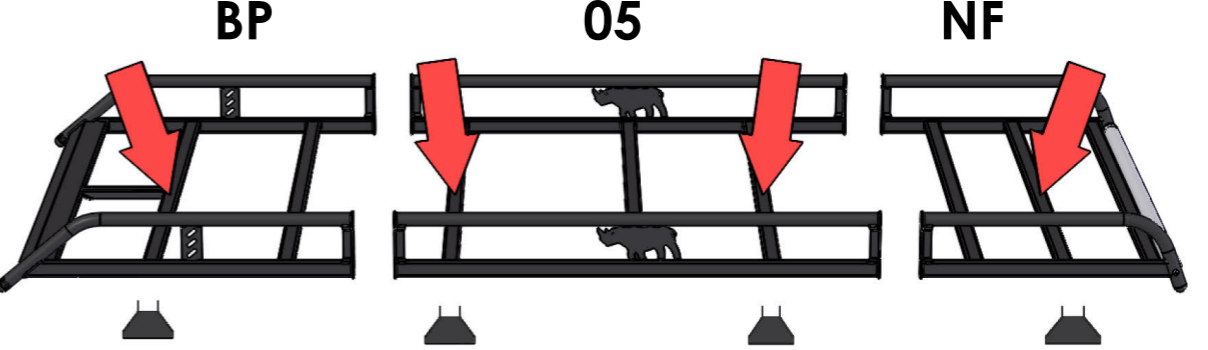
<h2>EU/R 508</h2>  <p>44kg + xx kg = Max. 150kg</p>	<h3>T5 TRANSPORTER 2002-SWB, LOW ROOF, TAILGATE</h3>  <p>3000mm 4890mm 1969mm</p>	 <p>BP O5 NF</p>
---	--	--

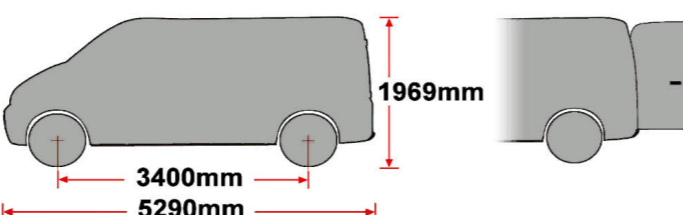
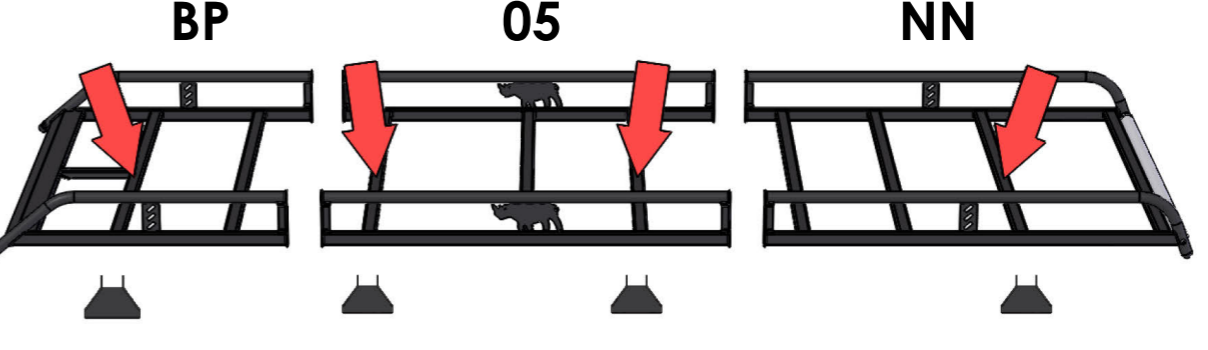
<h2>EU/R 509</h2>  <p>49kg + xx kg = Max. 150kg</p>	<h3>T5 TRANSPORTER 2002-LWB, LOW ROOF, TWIN DOORS</h3>  <p>3400mm 5290mm 1969mm</p>	 <p>BP O5 NN</p>
--	---	---

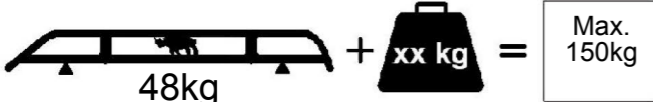
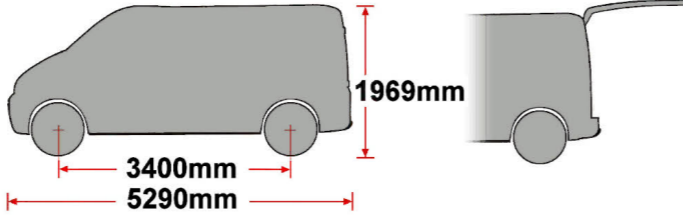
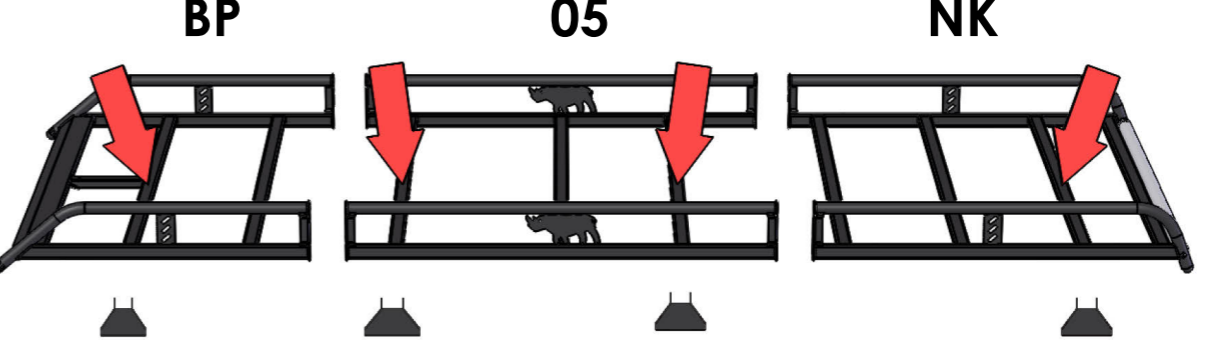
<h2>EU/R 510</h2>  <p>48kg + xx kg = Max. 150kg</p>	<h3>T5 TRANSPORTER 2002-LWB, LOW ROOF, TAILGATE</h3>  <p>3400mm 5290mm 1969mm</p>	 <p>BP O5 NK</p>
--	---	---

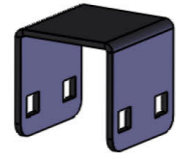

MS161 x 8



MS168 x 4



MS199 x 4



PS082 x 8



(FK126) x 1

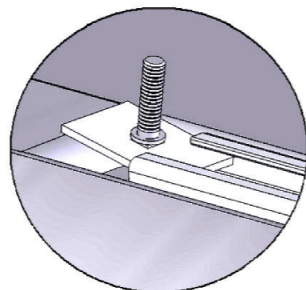

(ONLY required for vehicles with a T-Track roof system)

(1:1)



FB003 (M8 x 65) x 16

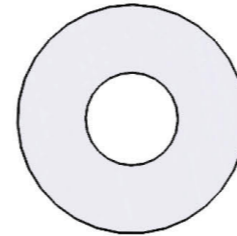

FW002 (M8) x 48

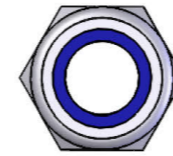

FN006 (M8) x 24

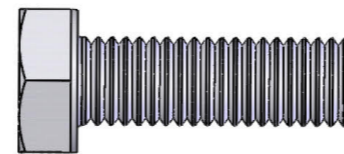

FS015 (M8 x 25) x 8



FS001 (M6 x 20) x 8

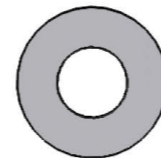

FW001 (M6) x 8



FW008 (M6) x 8

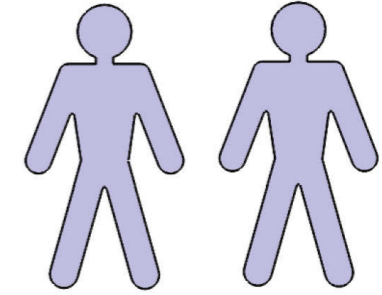

13mm x 2



10mm x 1

